

RoHS Compliant

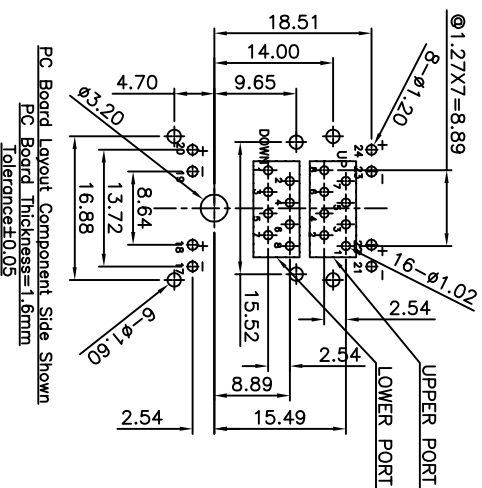
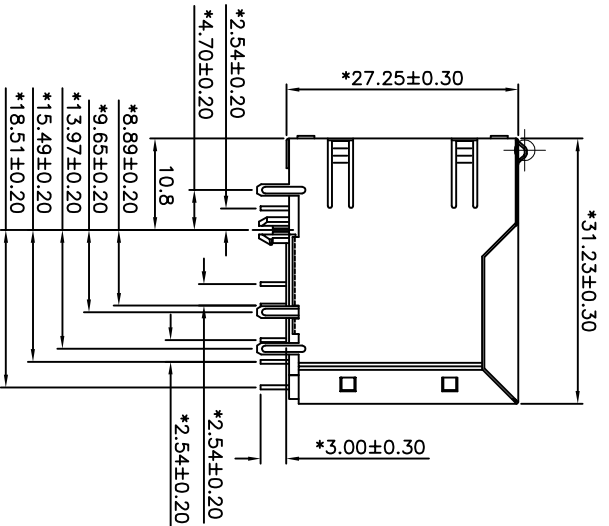
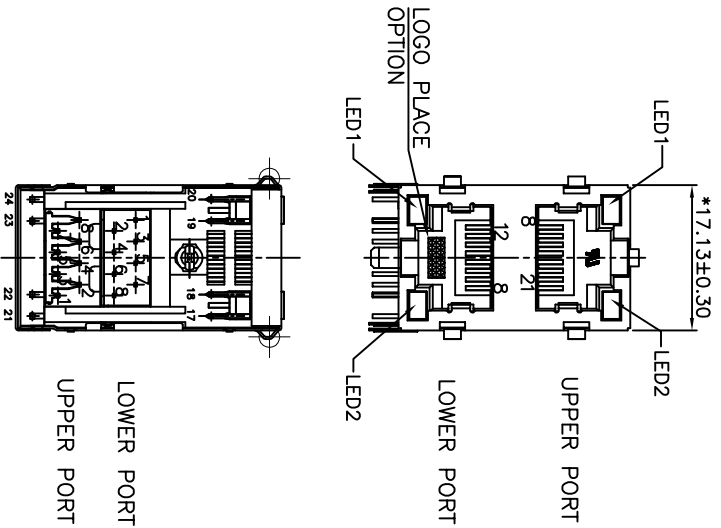

NOTES:

ELECTRICAL:

1. VOLTAGE RATING : 125 VAC RMS.
2. CURRENT RATING : 1.5 AMP.
3. CONTACT RESISTANCE : 60 MILLIOHMS MAX.
4. INSULATION RESISTANCE: 1000 MEGOHMS MIN @ 500 VDC.
5. DIELECTRIC STRENGTH : 1000 VDC RMS 60Hz, 1MIN.

MECHANICAL:

1. HOUSING MATERIAL : PBT+30%GF UL94V-0./COLOR:BLACK.
2. CONTACT MATERIAL : PHOSPHOR BRONZE t=0.35mm.
3. PLATING : GOLD PLATING OVER NICKEL.
4. OPERATING LIFE : 750 CYCLES MIN.
5. PCB RETENTION PRE-SOLDER : 1 LB MIN.
6. PCB RETENTION POST-SOLDER: 10 LB MIN.
7. LED COLOR : OPTION

ENVIRONMENTAL:

1. STORAGE : -40°C TO +85°C.
2. OPERATION : -40°C TO +85°C.
3. WAVE SOLDERING TEMPERATURE: 230~240°C(3~5 SECONDS).
4. ROHS COMPLIANT.

MATES WITH MODULAR PLUG CONFORMING TO  
FCC PART 68, SUBPART F.  
CUL FILE NO. E345295

- PART NUMBER: ZW2J88-XXXXL0XX
- 0-W/O LOGO
  - 1-W/ ZSNOW LOGO
  - 2-W/ LOGO
- GOLD OPTION:  
 1-3U" 2-6U" 3-15U"  
 4-30U" 5-50U" F-GOLD FLASH
- A-LED1:GREEN, LED2:GREEN  
 B-LED1:GREEN, LED2:ORANGE  
 C-LED1:GREEN, LED2:YELLOW  
 L-LED1:YELLOW, LED2:GREEN
- 1-W/O TAB  
 2-W/ TOP TABS  
 3-W/ SIDE TABS  
 4-W/ TOP TABS AND SIDE TABS

DIMENSION IN mm [Inch]

TOLERANCE UNLESS OTHERWISE SPECIFIED

.X ± 0.30	X. ± 2.0"
.XX ± 0.20	.X. ± 1.0"
.XXX ± 0.10	



ZSNOW ELECTRONIC CO., LTD

PART NUMBER SEE NOTE DRAWING NUMBER ZW2J88-XXXXL0XX-1

TITLE

RJ45 2\*1 LED JACK(STAMPED PIN)

APPROVE

TIMLEE 12/26/09'

CHECK

ZERO 12/26/09'

DRW

RACHEL 12/26/09'

PROJ. SCALE 5:4 SHEET 1 OF 1

REV P2