

RoHS Compliant

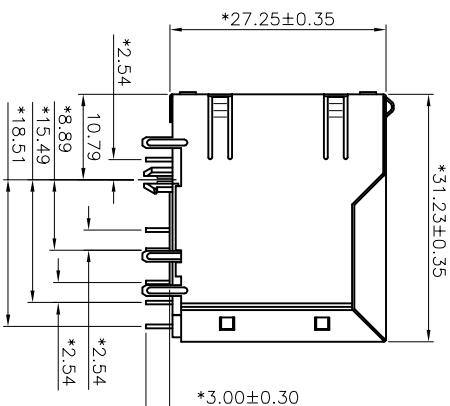
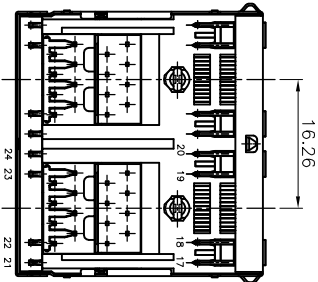
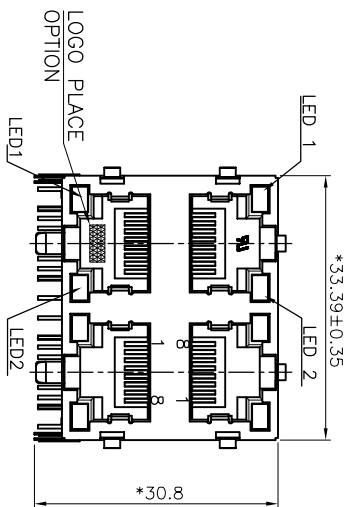

FOR P/N: ZW2J88-XX4A2BX

GREEN GREEN
12-LED1 10-LED1
RED RED
GREEN GREEN
12-LED1 10-LED1
RED RED

- NOTES:
- ELECTRICAL:**
- VOLTAGE RATING : 125 VAC RMS.
 - CURRENT RATING : 1.5 AMP.
 - CONTACT RESISTANCE : 50 MILLIOHMS MAX.
 - INSULATION RESISTANCE: 1000 MEGOHMS MIN @ 500 VDC.
 - DIELECTRIC STRENGTH : 1000 VAC RMS 60HZ, 1MIN.
- MECHANICAL:**
- HOUSING MATERIAL : PBT UL94V-0./COLOR:BLACK.
 - SHIELD MATERIAL : BRASS.
 - CONTACT MATERIAL : PHOSPHOR BRONZE t=0.35mm.
 - PLATING : GOLD PLATING OVER NICKEL.
 - OPERATING LIFE : 750 CYCLES MIN.
 - PCB RETENTION PRE-SOLDER : 1 LB MIN.
 - PCB RETENTION POST-SOLDER: 10 LBS MIN.
- ENVIRONMENTAL:**
- STORAGE : -40°C TO +85°C.
 - OPERATION: -40°C TO +85°C.
 - WAVE SOLDERING TEMPERATURE: 230~250°C(3~5 SECONDS).
 - RoHS COMPLIANT.
- MATES WITH MODULAR PLUG CONFORMING TO
FCC PART 68, SUBPART F.
CUL FILE NO. E345295
PART NUMBER: ZW2J88-XX4A2BX

PC Board Layout
Component Side Shown

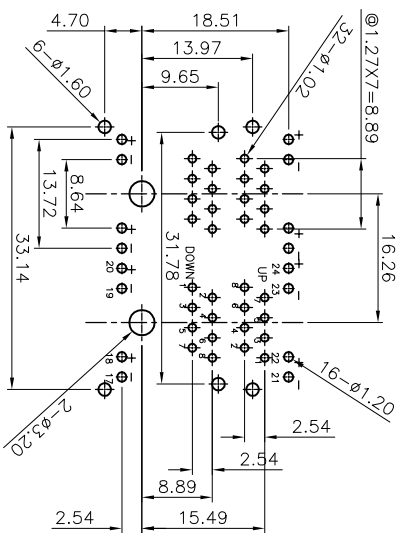

0-W/O LOGO LOGO
1-W/ ZSNOW LOGO
2-W/ F LOGO

1-3u" 2-6u" 3-15u"
4-30u" 5-50u" F-GOLD FLASH

A-LED1 GREEN, LED2 GREEN
B-LED1 GREEN, LED2 ORANGE
C-LED1 GREEN, LED2 YELLOW
L-LED1 YELLOW, LED2 GREEN
D-LED1 G+R, LED2 G+R

Inspection Item		DRAW		SCALE		SIZE		REV	
DIMENSION IN mm [Inch]		YANGLAN 10/10/10'		5 : 4		A3		P2	
TOLERANCE UNLESS OTHERWISE SPECIFIED		SEE NOTE		PROL		SHEET		OF	
.X ± 0.30		X ± 2.0°		10/10/10'		1		1	
.XX ± 0.20		.X ± 1.0°		10/10/10'		1		1	
.XXX ± 0.10		ZERO		10/10/10'		1		1	
PART NUMBER		DRAWING NUMBER		PART NUMBER		DRAWING NUMBER		PART NUMBER	
ZW2J88-XX4A2BX		ZW2J88-XX4A2BX		ZW2J88-XX4A2BX		ZW2J88-XX4A2BX		ZW2J88-XX4A2BX	
TITLE		RJA45(LED) STACKED GANGED JACK, 2X2		TITLE		RJA45(LED) STACKED GANGED JACK, 2X2		TITLE	
ZSNOW ELECTRONIC CO., LTD		ZSNOW ELECTRONIC CO., LTD		ZSNOW ELECTRONIC CO., LTD		ZSNOW ELECTRONIC CO., LTD		ZSNOW ELECTRONIC CO., LTD	

1 2 3 4 5 6 7 8